

CV Series Continuous Vacuum Packaging Machine Technical Specifications

Stainless steel construction for maximum durability and convenient cleaning. Equipped with a conveyor belt, the CV-1000 will operate in a semi-automatic or continuous operation, which increases output and reduces labor costs.

Production line operation can be achieved by adding an in feed and exit conveyor system.

If you need to package items containing liquids, the conveyor table can be adjusted to various angles, preventing products overflow. The conveyor belt can be easily washed down and the stainless steel chains meet food sanitation requirements.

Other standard features include a high efficiency Busch vacuum pump and a microprocessor controller with 14 program capability.

MODELS	CV-1000	CV-1200
Seal Bar Length	41.3"/1050mm	41.3"/1050mm
Distance Between Seal Bars	16.5"/420mm	22.8"/580mm
Chamber Depth	6.9"/175mm	7.9"/200mm
Vacuum Pump Capacity	100m ³ /h (4hp/2.5kw) 6.3A	305m ³ /h (12hp/8.9kw) 14.9A
Cycle	3~5 cycles/min	3~5 cycles/min
Voltage	220V/3ph/50Hz	220V/3ph/50Hz
Machine Weight	992 lbs /450kg	1296 lbs /588kg

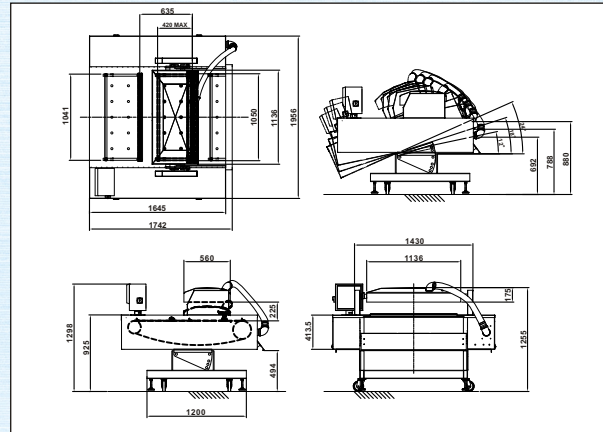

Available Options:

- Dual seal bars
- Voltage
- Sensor control
- Custom sizes available
- Vacuum pump



CV-1000

All specifications are subject to change without notice.